

## Soils Map

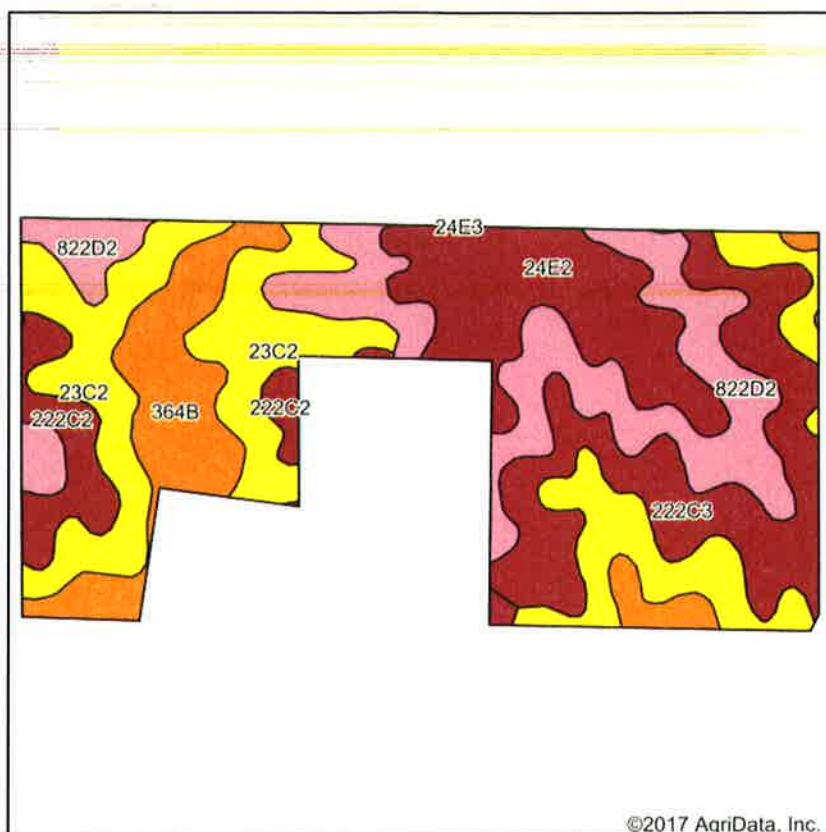

Soils data provided by USDA and NRCS.

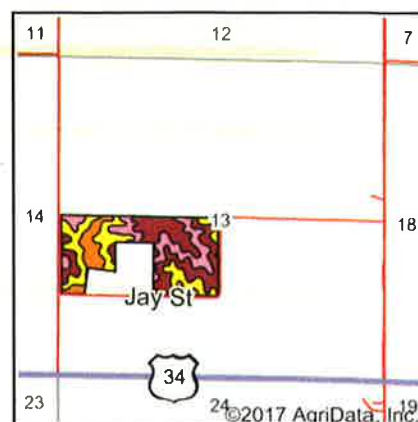

State: **Iowa**  
 County: **Clarke**  
 Location: **13-72N-24W**  
 Township: **Jackson**  
 Acres: **60**  
 Date: **1/10/2018**



Maps Provided By  
**surety**  
 CUSTOMIZED ONLINE MAPPING  
 © AgriData, Inc. 2017 www.AgriDataInc.com



Area Symbol: IA039, Soil Area Version: 23

Code	Soil Description	Acres	Percent of field	CSR2 Legend	Soil Drainage	Non-Irr Class *c	CSR2**	CSR
23C2	Arispe silty clay loam, 5 to 9 percent slopes, moderately eroded	16.78	28.0%		Somewhat poorly drained	IIe	62	50
822D2	Lamoni clay loam, 9 to 14 percent slopes, moderately eroded	12.45	20.8%		Somewhat poorly drained	IVe	30	15
222C3	Clarinda silty clay, 5 to 9 percent slopes, severely eroded	10.84	18.1%		Poorly drained	VIe	40	15
24E2	Shelby clay loam, 14 to 18 percent slopes, moderately eroded	8.62	14.4%		Well drained	IVe	40	33
364B	Grundy silty clay loam, 2 to 5 percent slopes	7.67	12.8%		Somewhat poorly drained	Ile	72	75
222C2	Clarinda silty clay loam, 5 to 9 percent slopes, moderately eroded	3.64	6.1%		Poorly drained	IVw	34	25
Weighted Average							47.8	35.7

\*\*IA has updated the CSR values for each county to CSR2.

\*c: Using Capabilities Class Dominant Condition Aggregation Method

Soils data provided by USDA and NRCS.